

TM 219-422-6448

TIPPMANN PNEUMATICS, INC.

OPERATOR'S MANUAL

**CO₂ POWERED
PAINT BALL GUN
CALIBER .60
MODEL SMG-60**

TIPPMANN PNEUMATICS, INC.



4402 New Haven Avenue Fort Wayne, Indiana 46803

SMG-60

"SNIPER" MODEL SMG-60 AUTOMATIC



"STANDARD" MODEL SMG-60 AUTOMATIC



"BULLDOG" MODEL SMG-60 AUTOMATIC

GENERAL

The SMG-60, semi/fully automatic rifle (cal. 60) is a modern, small arm produced in accordance with the most advanced manufacturing methods. It permits semi or full automatic fire from all positions.

The SMG-60 is a gas-operated rifle which fires from an open bolt, blow-back system. The paint balls are positive feed from a 15-round or optional 20-round magazine which holds either three or four 5-round stripper clips.

SPECIFICATIONS

Caliber60
Power	CO ₂ (7 oz. cylinder)
Mag. Capacity	15 (3-5 shot strips)
CO ₂ Capacity	350 shots per cylinder
Cycle Rate	600 RPM
SMG-60 Barrel Length	11"
SNIPER MODEL Barrel Length	16"
BULLDOG MODEL Barrel Length	8.5"
Length-Overall	29"
Weight	5 lbs
Effective Range	100 ft. plus
Action	Semi or full-auto open bolt blow-back

OPERATOR'S MANUAL

CO₂ POWERED PAINT BALL GUN
Caliber .60, Model SMG-60

TIPPMANN PNEUMATICS, INC.

Fort Wayne, Indiana
6/1/89

Warranty & Repair
1-800-533-4831

INDEX

Table of Contents	Page
General	1
Specifications	1
Assemblies ("Exploded" view of gun)	5
Description of Assemblies	
Assembly No. 1 - Barreled Receiver	2
Assembly No. 2 - Trigger and Sear Group	2
Assembly No. 3 - Bolt Group	2
Assembly No. 4 - Bolt Receiver Tube	2
Assembly No. 5 - Magazine Housing	2
Assembly No. 6 - Gun Valve	3
Assembly No. 7 - Stock (CO ₂ Cylinder)	3
Assembly No. 8 - Interior Gas Line	3
Assembly No. 9 - Stripper Clips	3
Operating Instructions	
1. CO ₂ Cylinder Connection & Removal	4
2. Safety	4
3. Loading	4
4. Firing	7
5. Removing CO ₂ Cylinder	7
Maintenance	
1-M. Cleaning Barrel	8
2-M. Before Storing	8
3-M. After Storage and Before Use	8
4-M. CO ₂ Cylinder Re-filling Instructions	8
Warranty & Repair Policy	10

DESCRIPTION OF ASSEMBLIES

Assembly No. 1 - Barreled Receiver

The receiver contains the barrel and sites. In addition all assemblies are either contained in the receiver or attached to it. The steel barrel is press fitted into the receiver and secured with "Loctite" adhesive.

Assembly No. 2 - Trigger and Sear Group

The trigger and sear are high-grade stress-proof steel. The trigger is fixed into the receiver with a 1/8" hardened steel cross pin and sprung forward with a stainless steel compression spring. The sear is fixed into the receiver with a 1/8" hardened steel cross pin and sprung rearward with a stainless steel tension spring.

Assembly No. 3 - Bolt Group

The bolt drive spring and drive spring rod are fitted into the receiver tube and held in place by the receiver end cap. The bolt handle is fitted through the left side of the receiver tube and into the bolt.

Assembly No. 4 - Receiver Tube

The steel receiver tube is fitted into the receiver and held in place by receiver end cap.

Assembly No. 5 - Magazine Housing

The magazine housing is rectangular steel tubing and bolts to the left side of the receiver with the constant force clip drive spring attached between the magazine housing and receiver with magazine housing bolt.

Assembly No. 6 - Gun Valve

The gun valve is fitted into the receiver body ahead of the receiver tube and held in place by a 1/8" split pin.

Assembly No. 7 - Stock/CO₂ Cylinder with Valve

The stock/CO₂ cylinder is a high strength aluminum alloy designated by the Aluminum Association as 6061 and heat treated to T8 temper. It should be noted that this cylinder is manufactured under Department of Transportation exemption number #DOT-E 7737-1800 and is the aluminum equivalent of #DOT-3E 1800 Cylinder. The cylinder has been inspected and the testing witnessed by an independent inspection agency.

Assembly No. 8 - Interior Gas Line

The interior gas line is composed of hydraulic tubing, a steel reinforcement spring, and high-pressure pneumatic fittings. Its purpose is to get the CO₂ from cylinder to the gun valve.

Assembly No. 9 - 5-Round Unbreakable Stripper Clips

The stripper clips are designed to friction-hold 5 rounds of .60 cal. ber paint balls. They can be used indefinitely, but are also economically replaced is lost.

OPERATING INSTRUCTIONS

1. CO₂ CYLINDER CONNECTION & REMOVAL

With gun unloaded and pointed in a safe direction, pull the bolt handle back to the cocked position. Hold gun body magazine housing in left hand. With right hand twist cylinder clockwise into rear end of receiver until tight. Gun should be fully charged and ready to fire. To test, insert empty clip, point upward in a safe direction and pull trigger halfway. Gun will cycle and fire gas only.

NOTE: The CO₂ cylinder comes complete with valve and butt plate. The valve stem visible in the end of the valve body is automatically depressed when threaded into the receiver body. This charges the gun with its CO₂ propellant.

The cylinder valve is opened in the last full clockwise twist of the cylinder (stock) into the receiver. To uncharge the gun, unload paint balls and stripper clips from gun. Twist the CO₂ cylinder (stock) one full turn counterclockwise. This closes the cylinder valve. Then fire the remaining CO₂ gas in the gun in a safe direction (approximately 3 shots).

2. SAFETY

Bolt handle acts as the Safety. Forward is "Safe" position. Pulled back; gun is cocked and ready to fire. To put gun in "Safe" position, let bolt handle forward by hand.

3. LOADING

With bolt handle in the forward or "Safe" position and paint balls inserted into the 5-round stripper clips, insert clips into

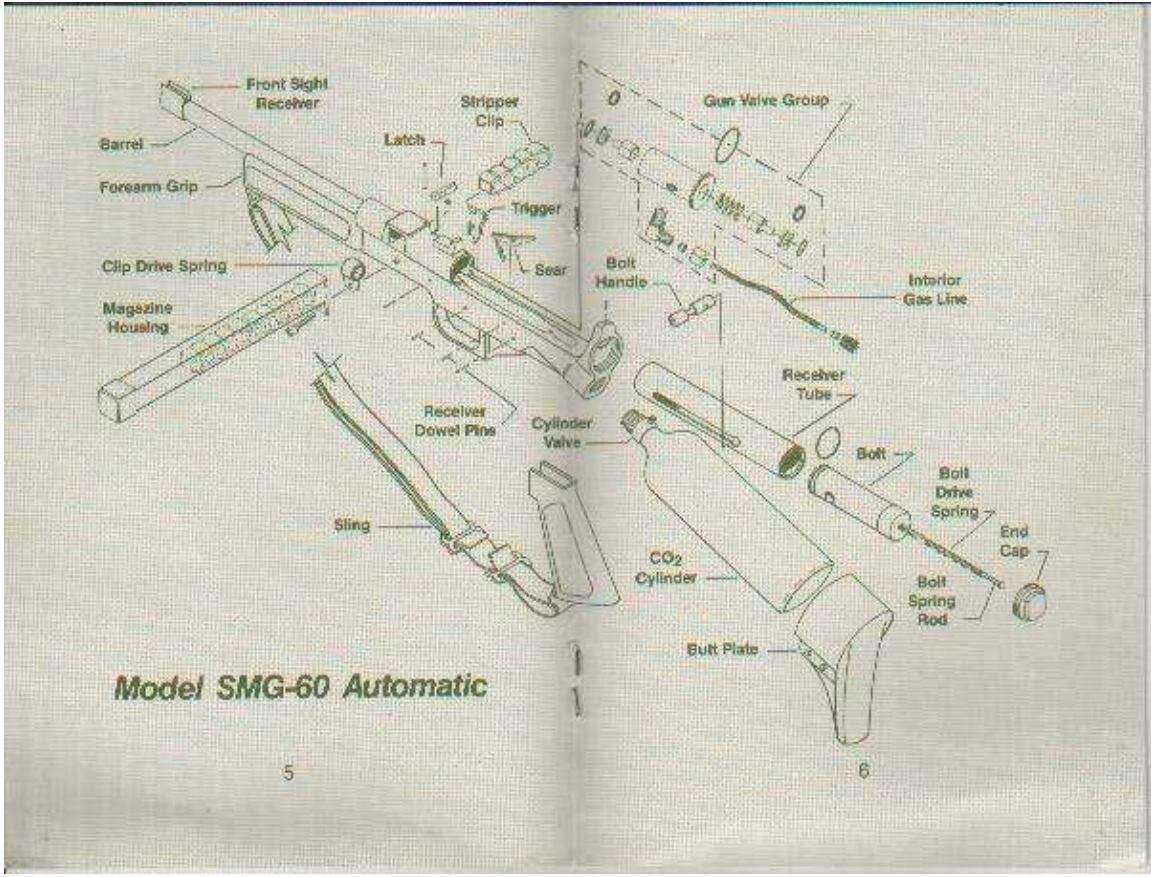

magazine housing from right side to receiver.

UNLOADING: To unload, push clip latch located on right side of gun forward with right hand thumb. Stripper clips will eject into right hand.

4. FIRING

Pull bolt handle back to firing position, sight in the target, pull trigger. **NOTE: Double-pull trigger:** To fire semi-automatic (one paint ball at a time), pull trigger only halfway and release. To fire full-automatic, pull trigger fully to the rear.

5. REMOVING CO₂ CYLINDER FOR STORAGE

Twist cylinder counterclockwise one half turn. Then, point the gun in a safe direction and pull trigger. **CAUTION:** Gun will fire approximately 3 more times until CO₂ charge in receiver is gone.) Now, twist cylinder free from receiver for storing or when not in use.

MAINTENANCE

1-M. CLEANING BARREL

If a paint ball should break in barrel, remove clip in firing position or push inward until clear of firing position. Find cleaning cable in Cleaning Kit. First, insert brass ball end into receiver end of barrel, and feed through barrel until brass ball end is through barrel. Then, pull brass ball until rubber grommet comes through with paint. (Barrel is clean.)

2-M. BEFORE STORING

Before storing gun, remove the CO₂ cylinder. Clean barrel and spray a little oil into barrel and receiver to prevent rust.

3-M. AFTER STORAGE AND BEFORE USE

Before installing CO₂, put a few drops of oil into gas hole in receiver where cylinder connects, plus a few drops of oil in receiver tube ahead of cocked bolt to lubricate bolt and O-ring. A little grease on cylinder valve O-ring will extend the durability of the O-ring.

NOTES: Empty clips will not index. The gas pressure behind paint ball when fired operates the automatic clip latch.

Do not dry-fire gun in downward position. When CO₂ cylinder is tipped downward, liquid CO₂ will enter gun and will greatly reduce the amount of shots contained in the cylinder.

magazine housing from right side to receiver.

UNLOADING: To unload, push clip latch located on right side of gun forward with right hand thumb. Stripper clips will eject into right hand.

4. FIRING

Pull bolt handle back to firing position, sight in the target, pull trigger. **NOTE: Double-pull trigger:** To fire semi-automatic (one paint ball at a time), pull trigger only halfway and release. To fire full-automatic, pull trigger fully to the rear.

5. REMOVING CO₂ CYLINDER FOR STORAGE

Twist cylinder counterclockwise one half turn. Then, point the gun in a safe direction and pull trigger. **CAUTION:** Gun will fire approximately 3 more times until CO₂ charge in receiver is gone.) Now, twist cylinder free from receiver for storing or when not in use.

MAINTENANCE

1-M. CLEANING BARREL

If a paint ball should break in barrel, remove clip in firing position or push inward until clear of firing position. Find cleaning cable in Cleaning Kit. First, insert brass ball end into receiver end of barrel, and feed through barrel until brass ball end is through barrel. Then, pull brass ball until rubber grommet comes through with paint. (Barrel is clean.)

2-M. BEFORE STORING

Before storing gun, remove the CO₂ cylinder. Clean barrel and spray a little oil into barrel and receiver to prevent rust.

3-M. AFTER STORAGE AND BEFORE USE

Before installing CO₂, put a few drops of oil into gas hole in receiver where cylinder connects, plus a few drops of oil in receiver tube ahead of cocked bolt to lubricate bolt and O-ring. A little grease on cylinder valve O-ring will extend the durability of the O-ring.

NOTES: Empty clips will not index. The gas pressure behind paint ball when fired operates the automatic clip latch.

Do not dry-fire gun in downward position. When CO₂ cylinder is tipped downward, liquid CO₂ will enter gun and will greatly reduce the amount of shots contained in the cylinder.

**INSTRUCTIONS FOR FILLING
TIPPMANN PNEUMATICS
7 oz. CO₂ Cylinders
(with enclosed adapter)**

1. Cylinders must be completely empty. To empty, depress valve pin on top of cylinder firmly against small, round object until completely empty.
2. Bulk cylinder for filling small CO₂ cylinder must have siphon tube. Bulk cylinders with siphon tubes are marked by red paint around top of cylinder.
3. To fill cylinder, first weigh the TPI 7 oz. cylinder when it is completely empty then install the TIPPMANN PNEUMATICS filling adapter on the bulk cylinder (hand tight). Then crack hand valve open until the gas in siphon tube escapes and liquid CO₂ appears in the form of a white smoke. Next, install empty TPI 7 oz. cylinder into adapter (hand tight) against rubber washer inside adapter, then open cylinder hand valve. After approximately 30 seconds, turn hand valve off and remove TPI 7 oz. cylinder.

NOTE: If 7 oz. cylinder was frosty cold when filled, it will have approximately 7 oz. of CO₂ gas in it.

If 7 oz. cylinder was warm, it will have approximately 3 oz. of CO₂ gas in it. To fill to 7 oz., depress valve pin on top of cylinder against small, round object until completely empty. This will frost or chill cylinder for final fill. While cylinder is chilled, repeat filling operations. Second filling should contain approximately 7 oz. of CO₂ gas.

4. To weigh cylinders, first weigh the cylinder when it is completely empty. Then weigh again when it is filled. Subtract the empty weight from the filled weight to tell the net weight of CO₂ gas in cylinder.

NOTE: If 7 oz. cylinder leaks after removing from bulk cylinder, tap valve pin with small, ball-peen hammer to clear dry ice from valve seat.

— 9 —

**WARRANTY
& REPAIR POLICY**

Tippmann Pneumatics, Inc. is dedicated to providing you with the ultimate paint ball gun and the quality support necessary for the utmost satisfaction in its use. In the event warranty or other non-warranty related repairs are required, we are here for you. We strive to complete within 24 hours of receipt, the necessary repair work for your gun and return it to you via UPS. For assistance with warranty & repair, call 1-800-533-4831.

WARRANTY STATEMENT

Tippmann Pneumatics, Inc. warrants that this product is found free from defects in materials and workmanship during the first 6 months from original date of purchase by the initial — owner/purchaser. On claims submitted as outlined in "Warranty Or Repair Procedure" Tippmann Pneumatics, Inc. will repair or replace "without charge" any of its guns that have failed through defect in material or workmanship.

WARRANTY OR REPAIR PROCEDURE

For Warranty And Non-Warranty Repair, ship or deliver your gun to Tippmann Pneumatics, Inc. postage or delivery charges prepaid, a brief statement regarding the requested repair, your name, address and telephone number where you can be reached during normal business hours, if possible.

— 10 —

STATEMENT OF LIABILITY

WARNING:

This rifle is classified as a dangerous weapon and is surrendered by Tippmann Pneumatics, Inc. with the understanding that the purchaser assumes all liability resulting from unsafe handling or any action that constitutes a violation of any applicable laws or regulations. Tippmann Pneumatics, Inc. shall not be liable for personal injury or loss of property or life resulting from the use of this rifle under any circumstances, including intentional, reckless, negligent or accidental discharges.

PLEASE BE CAREFUL!

WARRANTY REGISTRATION CARD

MODEL No. _____ SERIAL No. _____
PURCHASED FROM _____
DATE _____ CITY _____ STATE _____ ZIP _____
YOUR NAME (Please Print) _____
STREET No. _____
CITY _____ STATE _____ ZIP _____
PHONE _____

TIPPMANN PNEUMATICS, INC.
4402 New Haven Avenue
Fort Wayne, IN 46803